



RRP prices
1.1.2022 - 30.4.2022

EXW Vyssi Brod - Czech, without instalation and training

SuperSpeed CNC series

CashBack 1022,-€ + 5 year warranty after registration for manual driven machine





| SuperSpeed series |



manual driven machine

inclusive: rollholder top and side (with one bar), changeable height 85-100cm, 6x Up/Down button, 12 months warranty

	final price
SuperSpeed 300/160	8260,-€
SuperSpeed 300/210	11200,-€
SuperSpeed 400/160	8810,-€
SuperSpeed 400/210	11934,-€
SuperSpeed 500/160	11310,-€
SuperSpeed 500/210	18070,-€
SuperSpeed 600/160	14950,-€

Model 500/160, 600/160, 500/210 and 400/210 have to be installed fixed on legs.

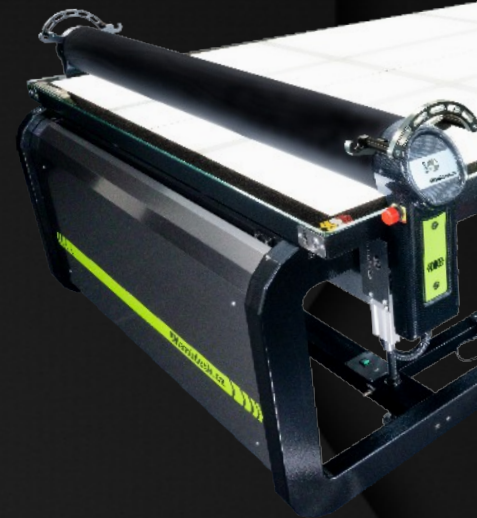

CashBack 1022,-€ + 5 year warranty after registration



SuperSpeed drive and EasyShift upgrade kit - for all machine sizes

SuperSpeed drive kit *	3450,-€
SuperSpeed drive + remote control	4100,-€
extended 5 year warranty	680,-€



*12 months warranty



**Each SuperSpeed frame is motor ready...
The Drive can be added to any SuperSpeed machine at any time.**



SuperSpeed backlight LED kit

SuperSpeed LED 300/160	1540,-€
SuperSpeed LED 300/210	1860,-€
SuperSpeed LED 400/160	1705,-€
SuperSpeed LED 400/210	2170,-€
SuperSpeed LED 500/160	2020,-€
SuperSpeed LED 500/210	2580,-€
SuperSpeed LED 600/160	2430,-€
extended 5 year warranty	292,-€



* all LEDs 12 months warranty

Each SuperSpeed frame is factory pre-wired and fitted with connectors...





heated roller - for all machine sizes

Heated roller xxx/xxx _____ **final price**
2200,-€



increased roller gap - for all machine sizes

roller gap 150mm _____ **2700,-€**

stroke 150mm

roller gap 300mm _____ **3600,-€**

stroke 150mm, for using material 150-300mm the machine has to be readjusted - 5 min work time



additional rollholder tube - for all machine sizes

rollholder tube _____ **225,-€**

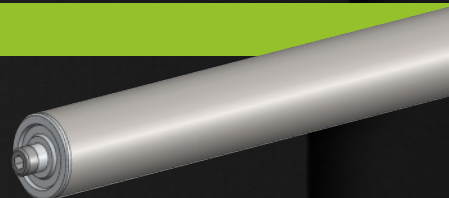

additional foot pedal

proportional foot pedal _____ **870,-€**

including extension cable and cable splitter



individual color

accessories color _____ **330,-€**

custom frame color _____ **630,-€**





| SuperSpeed series - Accessories |



Cutting mats

final price

for Lamidesk 300/160	_____	430,-€
for Lamidesk 300/210	_____	784,-€
for Lamidesk 400/160	_____	532,-€
for Lamidesk 400/210	_____	980,-€
for Lamidesk 500/160	_____	686,-€

excellent price



Integrated compressor

LC 30 for all Lamidesks supersilent 40dB	_____	690,-€
0,34kW, 33l/min, 8bar, 24l tank, 650x250x490, 26kg		



Stand-alone compressor

LC 30 for all Lamidesks supersilent 40dB	_____	530,-€
0,34kW, 33l/min, 8bar, 24l tank, 650x250x490, 26kg		



Rollstand

PLYWOOD ROLLSTAND
11 rolls - core 76mm

STAINLESS STEEL ROLLSTAND
14 rolls - core 76mm

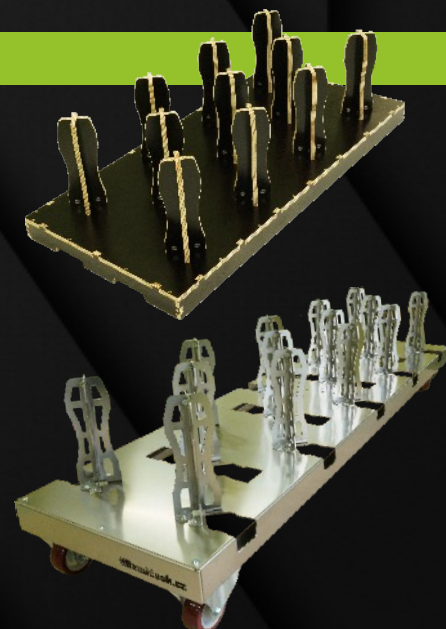



| Terms and Conditions |

Prices:

Prices:

All prices are net prices, excluding VAT, EXW Vyšší Brod ZIP: 382 73 - Czech Republic

Retention of title:

The delivered goods remains the property of the contractor until full payment has been received or until the check or bill of exchange has been honored.

Terms of warranty:

The warranty includes only spare parts needed to repair the machine.

The distributor is responsible to repair the machine and to send a request for the needed spare parts to Lamidesk. Lamidesk will offer a second level support for the distributor. It means Lamidesk will assist the distributor to define the error and give assistance, how to repair the machine, by phone.

Lamidesk will ship spare parts to an address recommended from the distributor. Damaged parts have to be sent immediately back to factory. If we don't receive these parts in 3 weeks after receiving new parts, we will invoice them to distributor.

Customer has to make proper and consistent photo documentation of delivered goods before unloading and immediately unpack it before the forwarder leaves. On the delivery note the customer confirms the goods was delivered without any obvious defects.

There is no warranty on the glass of working table!

There is no warranty, if the error results from vandalism or misusing the machine.

Furthermore, there is no warranty on roller, if there are cuts or wholes, done by the user.

To avoid loosing warranty on machine, the machine should be used only with eligible materials. If unsuitable materials were used there, or the machine was used uncorrectly, the client loses the right to the warranty.

All demands of warranty have to be sent in a written notice to:

Lamidesk s.r.o.

Street: **Hrudkov 79**

City: **Vyšší Brod, ZIP: 382 73**

Country: **Czech,**

VAT: **CZ05657741**

phone: **+420 604 349 624**

Machine ordering, information about delivery:

fakturace@lamidesk.cz +420 734 231 910

Spare parts ordering:

sklad@lamidesk.cz +420 604 264 029

Technical and sell support:

lamidesk@lamidesk.cz +420 604 349 624

lamidesk



MACHINE MODELS

each SuperSpeed frame is motor ready...
The Drive can be added to any
SuperSpeed machine at any time.

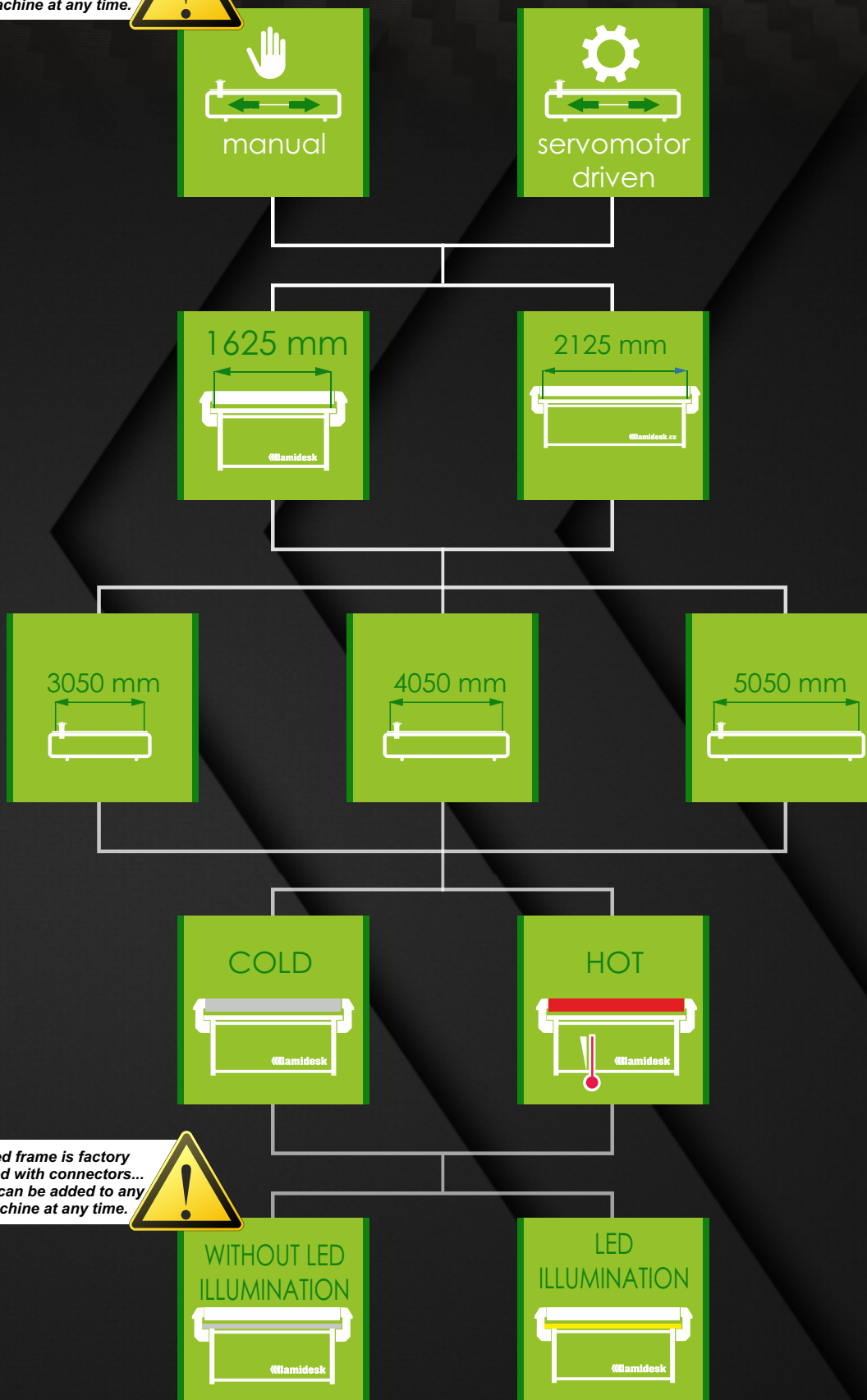

each SuperSpeed frame is factory
pre-wired and fitted with connectors...
The backlight set can be added to any
SuperSpeed machine at any time.

